

# PRACTICE WHAT YOU'VE LEARNED

Find the square footage of this house.

## FIRST FLOOR

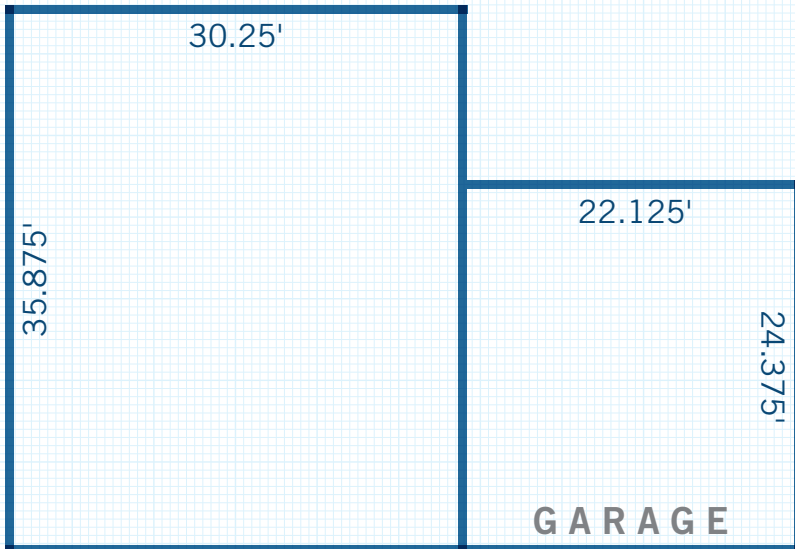

### According to the Appraisal District

1. Measure the exterior dimensions
2. Round to the nearest foot
3. Find the GLA of the first floor
4. Find the GLA of the second floor
5. Combine to find the total GLA

**TOTAL GLA:** \_\_\_\_\_

## SECOND FLOOR

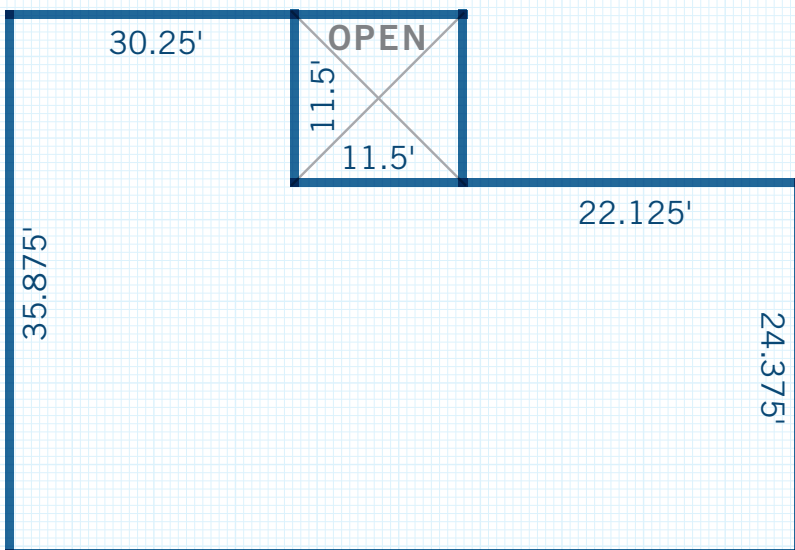

### According to the Appraiser using the ANSI process

1. Measure the exterior dimensions
2. Find the GLA of the first floor
3. Find the GLA of the second floor
4. Combine to find the total GLA

**TOTAL GLA:** \_\_\_\_\_

## ANSWERS:

### Appraisal District:

First floor GLA:  $36' \times 30' = 1,080$  sq ft

Second floor GLA:  $(36' \times 30') + (22' \times 24') = 1,608$  sq ft

Total GLA:  $1,080 + 1,608 = 2,688$  sq ft

### Appraiser using the ANSI process:

First floor GLA:  $35.9' \times 30.3' = 1,087.77$  sq ft

Second floor GLA:  $(35.9' \times 30.3') + (22.1' \times 24.4') - (11.5' \times 11.5') = 1,494.76$  sq ft

Total GLA: 2,583 sq ft